

**9 W W8^**

Provide MYSON B27 EUROPEAN TRADITION hydronic towel warmer including accessories as scheduled. European Tradition towel warmers are made of 1-1/4" brass tube and fittings in a variety of finishes. The B27 hydronic towel warmer is approved for installation on closed loop hydronic hot water systems only.

Each B27 towel warmer is constructed with integral 3-1/4" diameter wall and floor mounting flanges that are welded onto the back and bottom. The towel warmers are equipped with a manual air vent. Every unit is factory filled, tested and inspected to insure the finest quality product.

**3hs^ST^W8^ [eZW6,**

Polished Chrome, Polished Nickel, Satin Nickel, Regal Brass, Oil-Rubbed Bronze, White

**Efs^ VSdV 5a` ` Wf[a` s:**

2 x internal thread G 1/2" BSP

**Maximum positive operating pressure: 77psi**

**Maximum operating temperature: 230° F**

**Heat Output: 1080 BTUH @ 155° F**  
Entering Water Temperature

**I WYZf,**  
23 lbs.

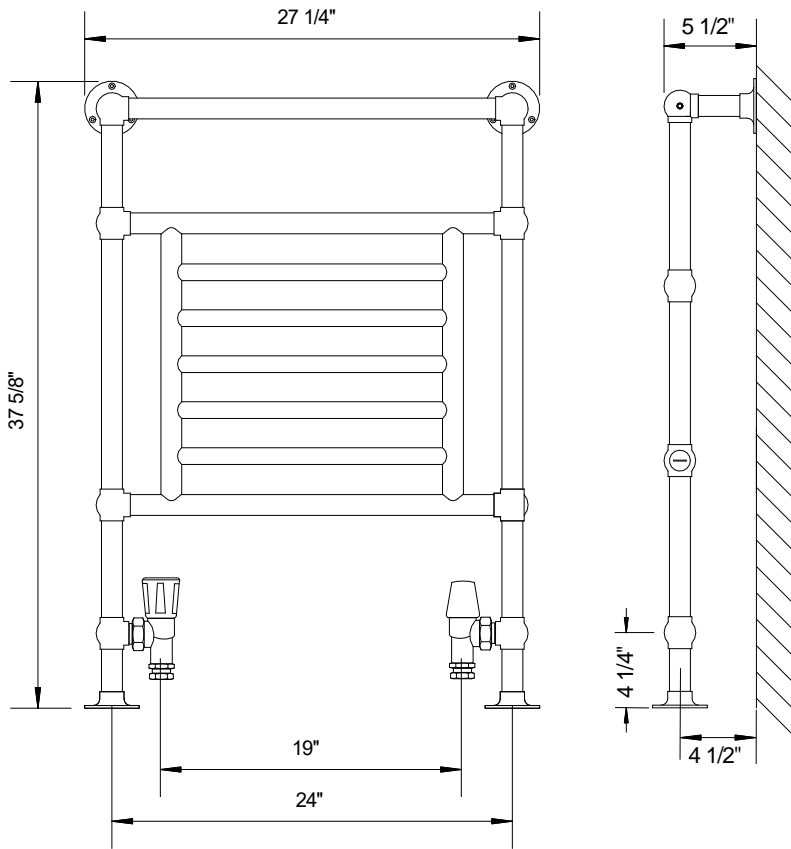

**NOTE:** Valve rough-in centers may vary from 18 1/2" - 19" depending on valve spud insertion depth.



**Standard Valve Set - STDVKIT**  
The set includes one (1) FF16WAC adjustable and (1) FF16LAC non-adjustable 1/2" valve. Available only with chrome angle body and white handles



**Modern Valve Set - V16A**  
"Angle" or V165 "Straight" pattern. Straight valves are normally used when the pipes come from the floor instead of the wall. Available in matching finishes.



**Cross Handle Valve Set - CHV16**  
The set includes two (2) Cross Handle valves. The Cross Handle valves are only available in an angle pattern and are available in matching finishes.



**Sleeve Kit - SK16** The set includes two (2) .656" I.D. x 3" brass sleeves and two (2) 2" diameter brass escutcheons. Available in matching finishes.

Optional valves and sleeve kits are recommended and available from **MYSON**.



**1 Sdb^ fk,**

**MYSON** European Tradition Towel Warmers are covered by a 10 year warranty.

**Quality certificates**



PROJECT NAME:  
ARCHITECT:  
ENGINEER:  
SUBMITTED DATE:

APPROVED DATE:

